

# Bexar County Inventory of Closed or Abandoned Landfills

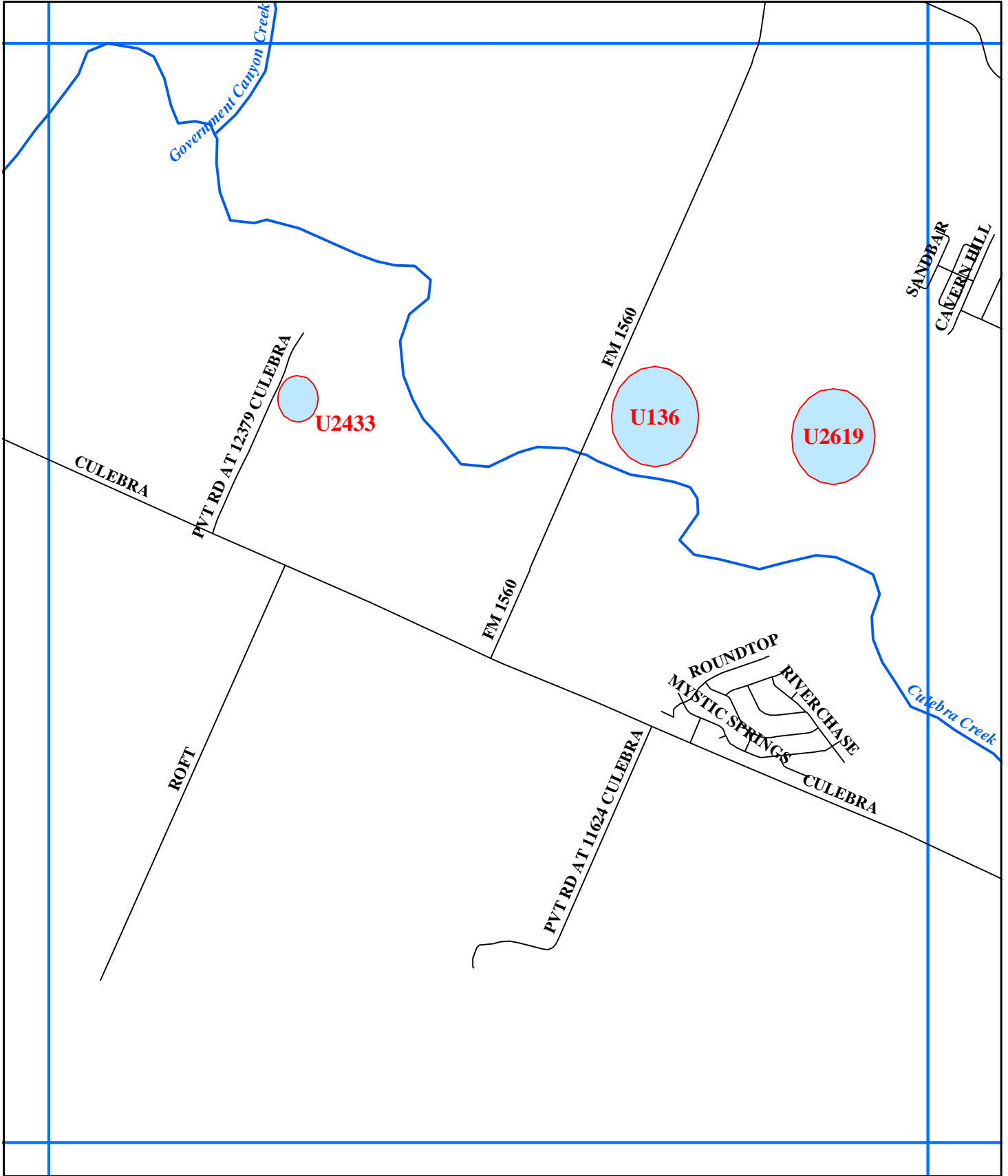

**CLOSED LANDFILL INVENTORY**  
Alamo Area Council of Governments

**SITE IDENTIFICATION**

Site Number	U136
Authorization	Unauthorized
Site Name	Stolte Dump
Alternate Site Name	
County	Bexar

**SITE HISTORY**

Year Opened	Unknown
Year Closed	1972
Size in Acres	20
Applicant Name	Unknown
Owner at Time of Operation	Charlotte Clark

**LOCATION**

Existence	Probable
Boundary Determined By	Boundary not determined
Latitude	29.51°
Longitude	98.72°
Location Description	0.5 miles NNE of FM471 and FM1560 intersection on eastside of FM1560
Nearest City	San Antonio

**LAND USE AND OWNERSHIP**

Date of Information	2002
Land Use	Vacant ranchland(D1)
Land Owner	Charlotte Clark
Address	7860 FM 1560 N San Antonio, TX 78254

**ATTACHMENTS AVAILABLE FOR REFERENCE**

Metes and Bounds Description	No
Location Map	Yes – See Bexar CLI Inventory D-8
Supporting Information	Yes
Photos	Yes

**COMMENTS**

Same as TNRC site #30686 See disclaimer on Bexar County Index Map.

**STATUS**

Completion Date	02/19/02
-----------------	----------

**CLOSED LANDFILL INVENTORY**  
Alamo Area Council of Governments

**SITE IDENTIFICATION**

Site Number	U2433
Authorization	Unauthorized
Site Name	Roland J Weidner
Alternate Site Name	
County	Bexar

**SITE HISTORY**

Year Opened	1984
Year Closed	1984
Size in Acres	5
Applicant Name	Unknown
Owner at Time of Operation	Roland J Weidner

**LOCATION**

Existence	Probable
Boundary Determined By	Boundary not determined
Latitude	29.51°
Longitude	98.74°
Location Description	2 miles west of FM471 and Loop 1604 intersection on north side of FM 471
Nearest City	San Antonio

**LAND USE AND OWNERSHIP**

Date of Information	2002
Land Use	Vacant ranchland (D1)
Land Owner	Ursula Weidner
Address	12163 W FM 471 San Antonio, TX 78253

**ATTACHMENTS AVAILABLE FOR REFERENCE**

Metes and Bounds Description	No
Location Map	Yes – See Bexar CLI Inventory D-8
Supporting Information	Yes
Photos	No

**COMMENTS**

Same as TNRC site #30808 See disclaimer on Bexar County Index Map.

**STATUS**

Completion Date	02/19/02
-----------------	----------

**CLOSED LANDFILL INVENTORY**  
Alamo Area Council of Governments

**SITE IDENTIFICATION**

Site Number	U2619
Authorization	Unauthorized
Site Name	Helotes #48
Alternate Site Name	
County	Bexar

**SITE HISTORY**

Year Opened	Unknown
Year Closed	Unknown
Size in Acres	20
Applicant Name	Unknown
Owner at Time of Operation	Unknown

**LOCATION**

Existence	Possible
Boundary Determined By	Boundary not determined
Latitude	29.51°
Longitude	98.72°
Location Description	Eastside of FM1560 outside Loop410
Nearest City	San Antonio

**LAND USE AND OWNERSHIP**

Date of Information	2002
Land Use	Vacant tracts of land; Can't have improvements (D4)
Land Owner	KB Home Lone Star LP
Address	4800 Fredericksburg San Antonio, TX 78229

**ATTACHMENTS AVAILABLE FOR REFERENCE**

Metes and Bounds Description	No
Location Map	Yes – See Bexar CLI Inventory D-8
Supporting Information	No
Photos	No

**COMMENTS**

Same as 1989 San Antonio Site #10 See disclaimer on Bexar County Index Map.

**STATUS**

Completion Date	02/19/02
-----------------	----------

